

Soils Map

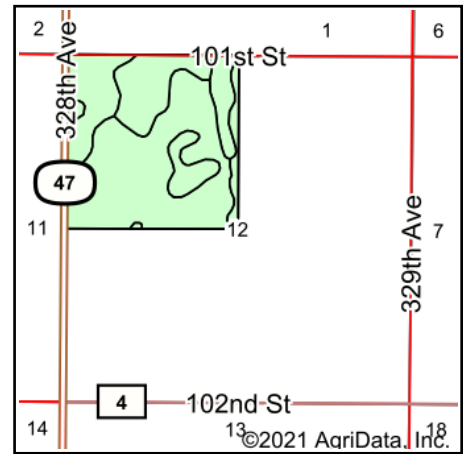
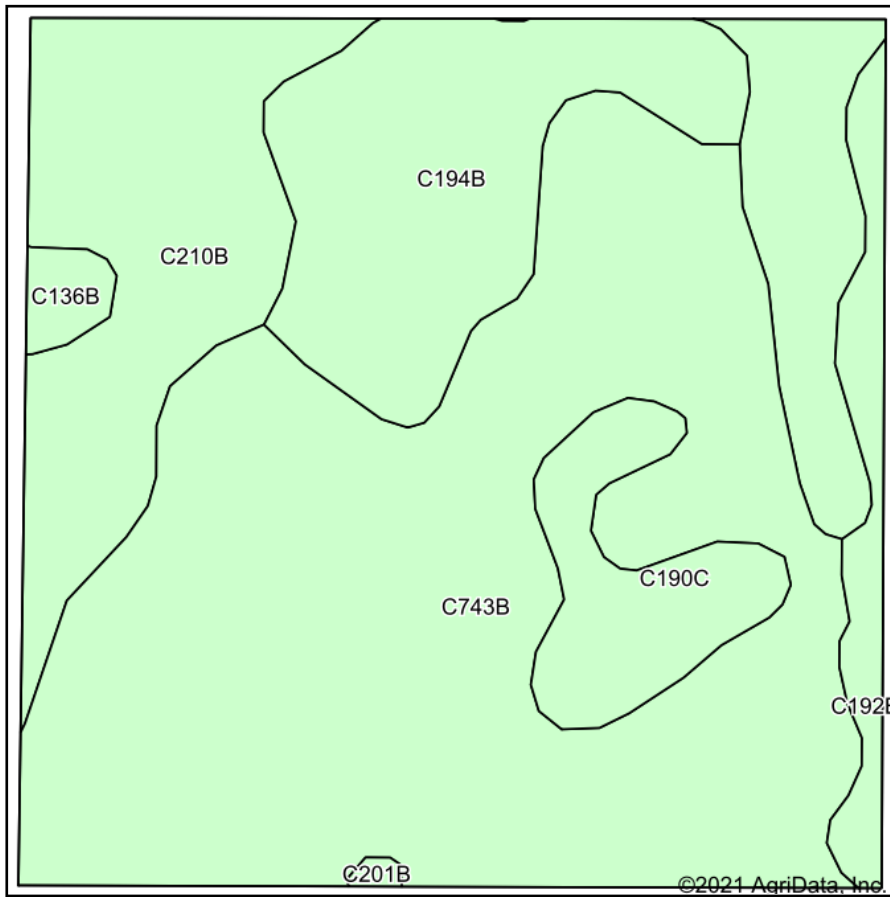

State: **South Dakota**
 County: **McPherson**
 Location: **12-128N-73W**
 Township: **West McPherson**
 Acres: **159.32**
 Date: **9/13/2021**

ADVANTAGE
Land Co.

Maps Provided By:

 CUSTOMIZED ONLINE MAPPING
 © AgriData, Inc. 2021 www.AgriDataInc.com



Area Symbol: SD089, Soil Area Version: 21

Code	Soil Description	Acres	Percent of field	Non-Irr Class *c	Productivity Index
C743B	Temvik-Grassna-Bearpaw complex, 0 to 6 percent slopes	85.69	53.8%	Ile	87
C210B	Williams-Bowbells loams, 3 to 6 percent slopes	33.72	21.2%	Ile	83
C194B	Bearpaw-Zeeland loams, 3 to 6 percent slopes	22.86	14.3%	Ile	76
C190C	Bearpaw loam, 6 to 9 percent slopes	9.13	5.7%	IIle	62
C192B	Bearpaw-Greenway loams, 3 to 6 percent slopes	6.00	3.8%	Ile	79
C136B	Williams-Zahl loams, 3 to 6 percent slopes	1.64	1.0%	Ile	76
C201B	Bowbells loam, 3 to 6 percent slopes	0.28	0.2%	Ile	89
Weighted Average					82.7

*c: Using Capabilities Class Dominant Condition Aggregation Method
 Soils data provided by USDA and NRCS.