

Soils Map

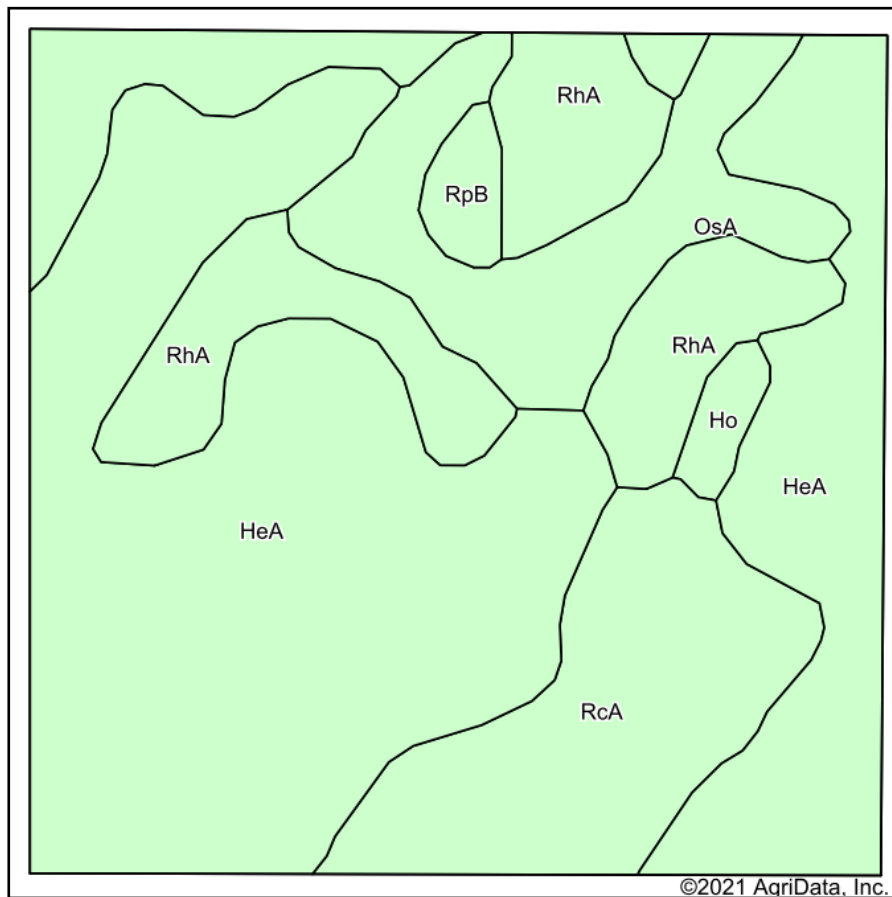

Soils data provided by USDA and NRCS.

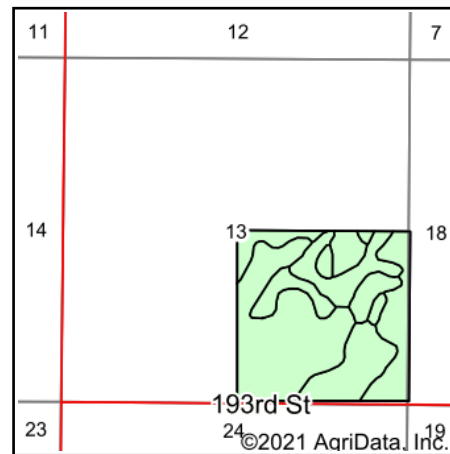

State: **South Dakota**
 County: **Sully**
 Location: **13-113N-76W**
 Township: **East Sully**
 Acres: **157**
 Date: **6/29/2021**

ADVANTAGE
Land Co.

Maps Provided By:



Area Symbol: SD119, Soil Area Version: 23

Code	Soil Description	Acres	Percent of field	Non-Irr Class *c	Productivity Index
HeA	Highmore silt loam, 0 to 2 percent slopes	84.81	54.0%	IIc	92
RhA	Eakin-Raber complex, 0 to 2 percent slopes	29.75	18.9%	IIc	83
RcA	Raber-Cavo loams, 0 to 2 percent slopes	21.32	13.6%	IIc	60
OsA	Onita-Hoven silt loams, 0 to 1 percent slopes	17.09	10.9%	IIc	59
RpB	Raber-Peno loams, 2 to 6 percent slopes	2.21	1.4%	Ile	65
Ho	Hoven silt loam, 0 to 1 percent slopes	1.82	1.2%	VIIs	15
Weighted Average					81.1

*c: Using Capabilities Class Dominant Condition Aggregation Method
 Soils data provided by USDA and NRCS.