

# Soils Map

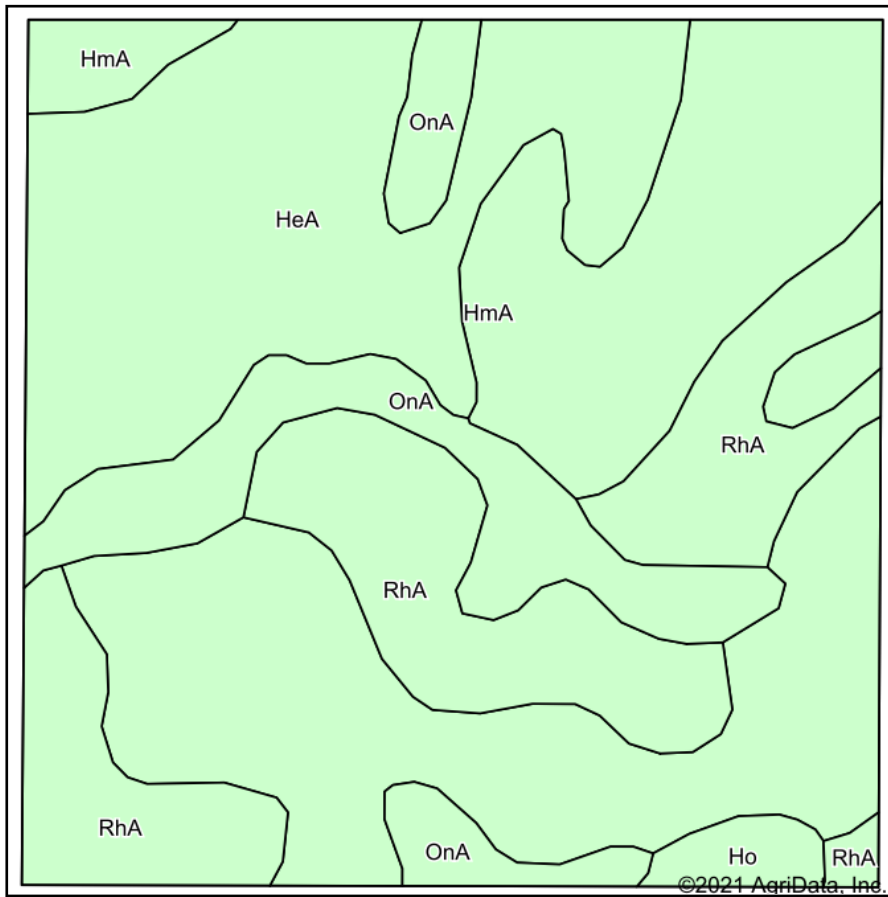

Soils data provided by USDA and NRCS.

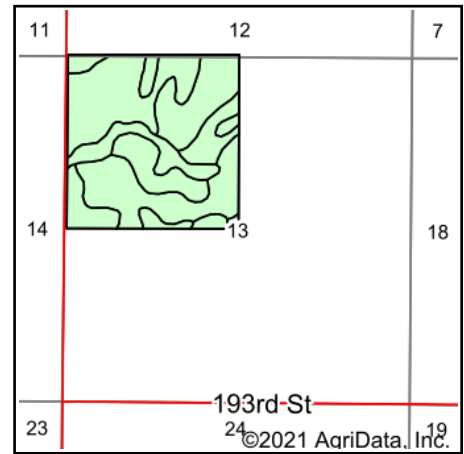

State: **South Dakota**  
 County: **Sully**  
 Location: **13-113N-76W**  
 Township: **East Sully**  
 Acres: **158.81**  
 Date: **6/29/2021**

**ADVANTAGE**  
*Land Co.*

Maps Provided By:



Area Symbol: SD119, Soil Area Version: 23

Code	Soil Description	Acres	Percent of field	Non-Irr Class *c	Productivity Index
HmA	Highmore-Walke silt loams, 0 to 2 percent slopes	63.70	40.1%	IIc	85
HeA	Highmore silt loam, 0 to 2 percent slopes	39.86	25.1%	IIc	92
RhA	Eakin-Raber complex, 0 to 2 percent slopes	34.09	21.5%	IIc	83
OnA	Mobridge silt loam, 0 to 2 percent slopes	18.90	11.9%	IIc	94
Ho	Hoven silt loam, 0 to 1 percent slopes	2.26	1.4%	VIIs	15
<b>Weighted Average</b>					<b>86.4</b>

\*c: Using Capabilities Class Dominant Condition Aggregation Method  
 Soils data provided by USDA and NRCS.