

# Soils Map

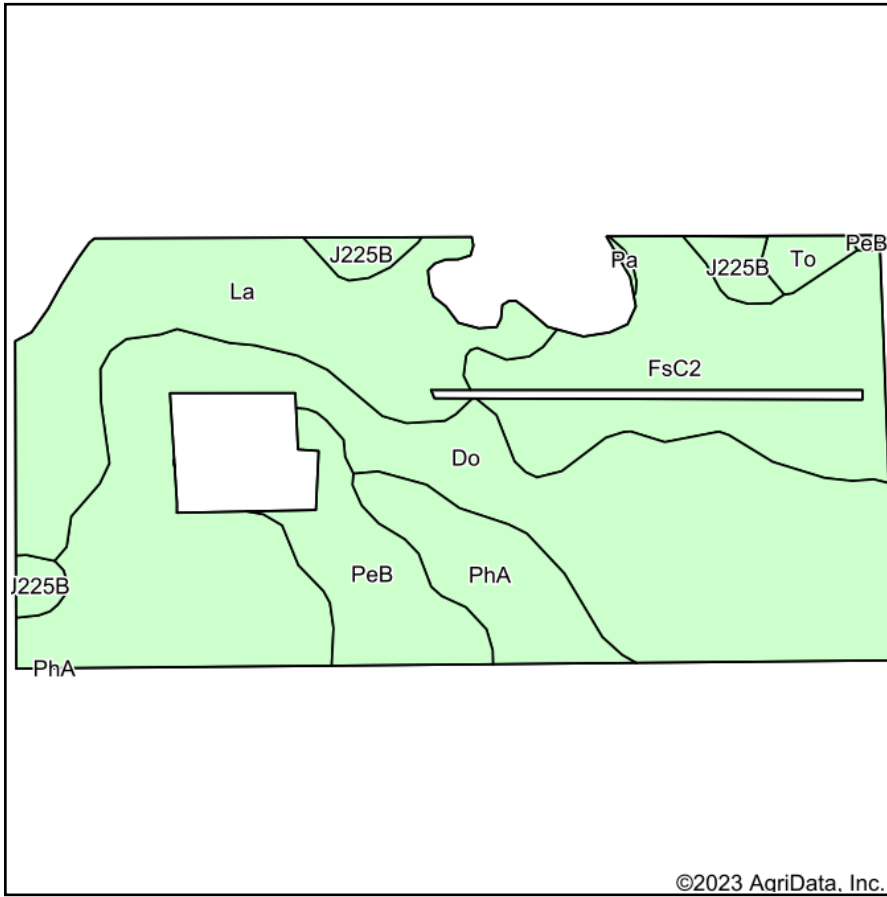

Soils data provided by USDA and NRCS.

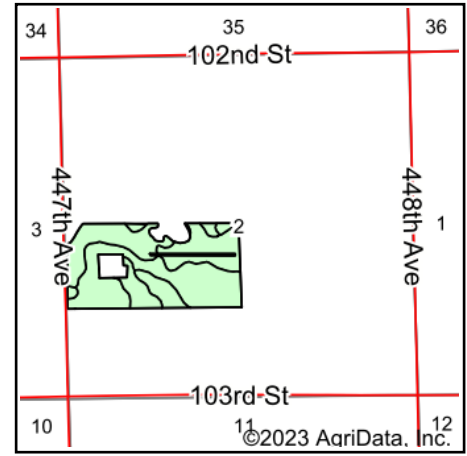

State: **South Dakota**  
 County: **Marshall**  
 Location: **2-128N-53W**  
 Township: **Veblen**  
 Acres: **70.11**  
 Date: **9/21/2023**

**ADVANTAGE**  
*Land Co.*

Maps Provided By:



Area Symbol: SD091, Soil Area Version: 23

Code	Soil Description	Acres	Percent of field	Non-Irr Class *c	Productivity Index
Do	Castlewood silty clay	30.50	43.5%	IVw	60
La	Lamoure silty clay loam, 0 to 2 percent slopes, occasionally flooded	14.11	20.1%	IIIw	68
FsC2	Forman-Buse loams, 6 to 9 percent slopes, eroded	12.82	18.3%	IIIe	61
PeB	Peever clay loam, 2 to 6 percent slopes	5.07	7.2%	IIIe	68
PhA	Peever-Hamerly complex, 0 to 2 percent slopes	4.66	6.6%	IIs	74
J225B	Forman-Aastad complex, 1 to 4 percent slopes	2.09	3.0%	Ile	88
To	Tonka silty clay loam, 0 to 1 percent slopes	0.78	1.1%	IVw	58
Pa	Parnell silty clay loam	0.08	0.1%	Vw	30
<b>Weighted Average</b>				<b>3.35</b>	<b>64.1</b>

\*c: Using Capabilities Class Dominant Condition Aggregation Method  
 Soils data provided by USDA and NRCS.