

Soils Map

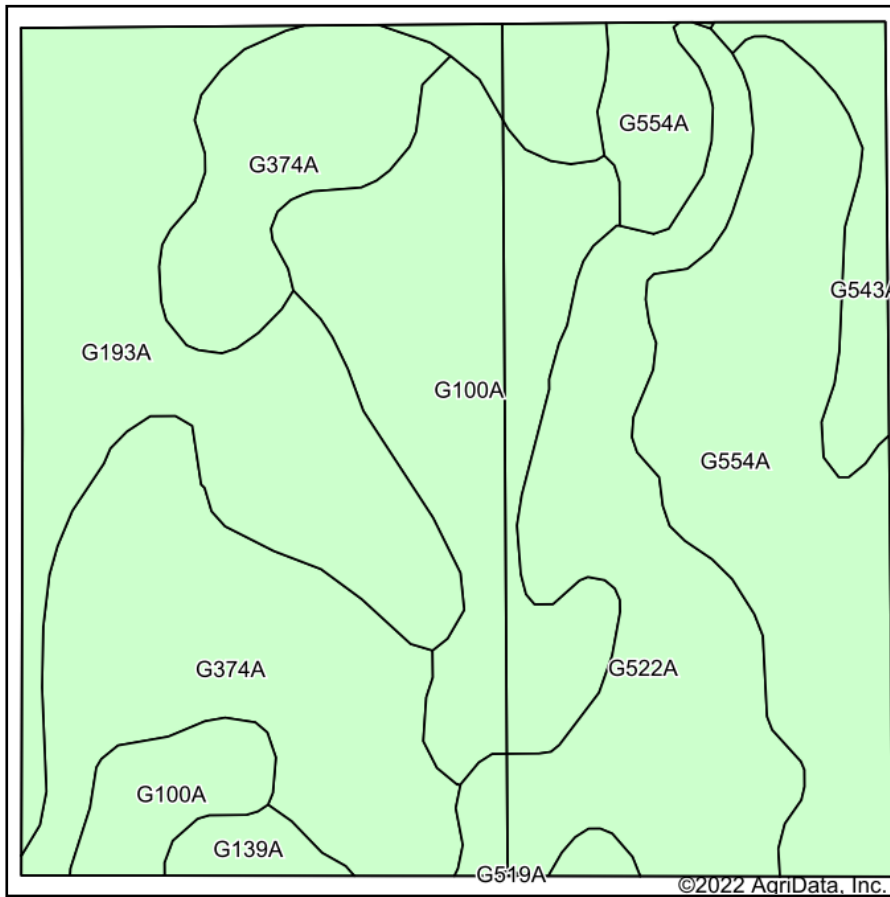

Soils data provided by USDA and NRCS.

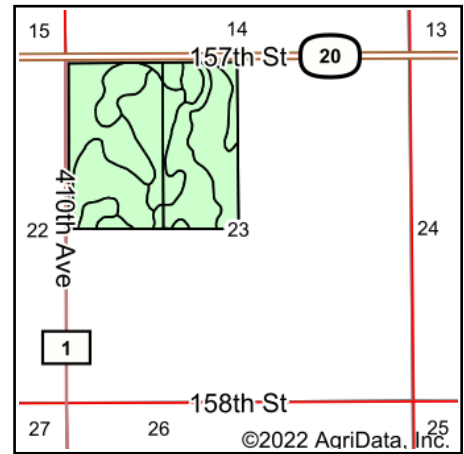

State: **South Dakota**
 County: **Spink**
 Location: **23-119N-60W**
 Township: **Olean**
 Acres: **150.44**
 Date: **11/1/2022**

ADVANTAGE
Land Co.

Maps Provided By:

 CUSTOMIZED ONLINE MAPPING
 © AgriData, Inc. 2021 www.AgriDataInc.com



Area Symbol: SD115, Soil Area Version: 22

Code	Soil Description	Acres	Percent of field	Non-Irr Class *c	Productivity Index
G374A	Egeland-Embsen complex, 0 to 2 percent slopes	32.21	21.4%	IIIe	64
G193A	Aastad-Forman loams, 0 to 3 percent slopes	30.59	20.3%	IIc	92
G554A	Harriet loam, 0 to 1 percent slopes, occasionally flooded	28.72	19.1%	VIIs	21
G100A	Hamerly-Tonka complex, 0 to 3 percent slopes	28.58	19.0%	Ile	64
G522A	Lowe loam, 0 to 1 percent slopes, frequently flooded	23.65	15.7%	VIW	22
G543A	Playmoor silty clay loam, 0 to 2 percent slopes, frequently flooded	4.90	3.3%	VIW	24
G139A	Forman-Cresbard loams, 0 to 3 percent slopes	1.79	1.2%	IIc	79
Weighted Average				3.74	53.8

*c: Using Capabilities Class Dominant Condition Aggregation Method
 Soils data provided by USDA and NRCS.