

Soils Map

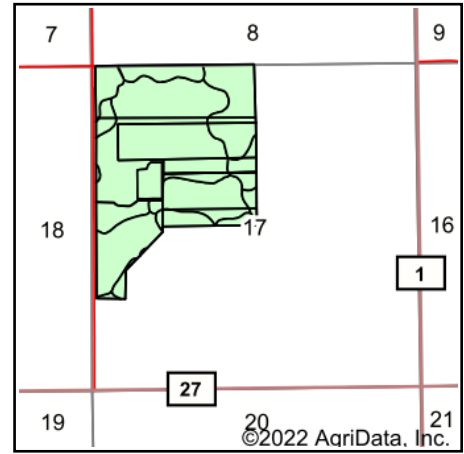
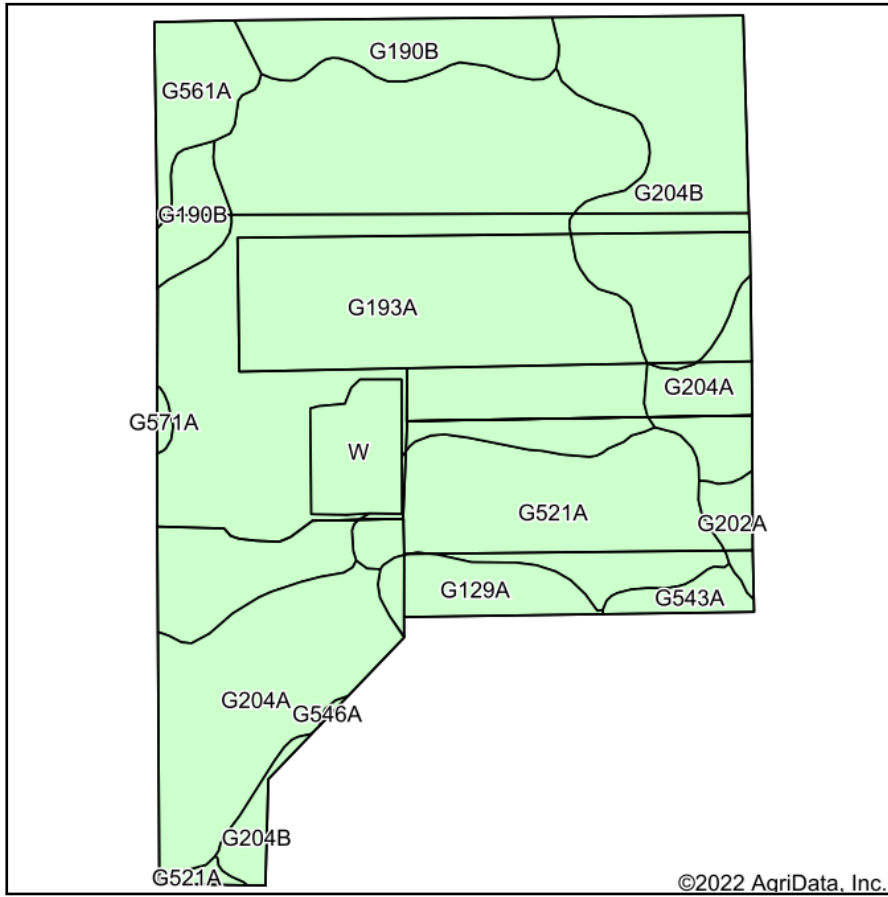

State: **South Dakota**
 County: **Clark**
 Location: **17-117N-59W**
 Township: **Raymond**
 Acres: **174.91**
 Date: **12/1/2022**

ADVANTAGE
Land Co.

Maps Provided By:

 CUSTOMIZED ONLINE MAPPING
 © AgriData, Inc. 2021 www.AgriDataInc.com



Area Symbol: SD025, Soil Area Version: 25

Code	Soil Description	Acres	Percent of field	Non-Irr Class *c	Productivity Index
G193A	Aastad-Forman loams, 0 to 3 percent slopes	79.87	45.7%	IIc	92
G204B	Peever clay loam, 3 to 6 percent slopes	23.16	13.2%	IIIe	66
G204A	Peever clay loam, 0 to 3 percent slopes	23.06	13.2%	IIIs	74
G521A	Lowe loam, 0 to 1 percent slopes, occasionally flooded	19.22	11.0%	IVw	41
G190B	Forman-Buse-Aastad loams, 1 to 6 percent slopes	10.32	5.9%	IIe	79
G561A	La Prairie loam, 0 to 2 percent slopes, occasionally flooded	5.34	3.1%	IIc	84
W	Water	4.94	2.8%	VIII	0
G129A	Cavour-Ferney loams, 0 to 3 percent slopes	4.85	2.8%	IVs	35
G543A	Playmoor silty clay loam, 0 to 2 percent slopes, frequently flooded	1.96	1.1%	VIw	24
G202A	Peever-Cavour complex, 0 to 3 percent slopes	1.77	1.0%	IIIs	61
G571A	LaDelle silt loam, 0 to 2 percent slopes, occasionally flooded	0.33	0.2%	IIc	92
G546A	Lowe loam, saline, 0 to 1 percent slopes, occasionally flooded	0.09	0.1%	IVw	34
Weighted Average				2.62	74.3

*c: Using Capabilities Class Dominant Condition Aggregation Method
 Soils data provided by USDA and NRCS.