

Soils Map

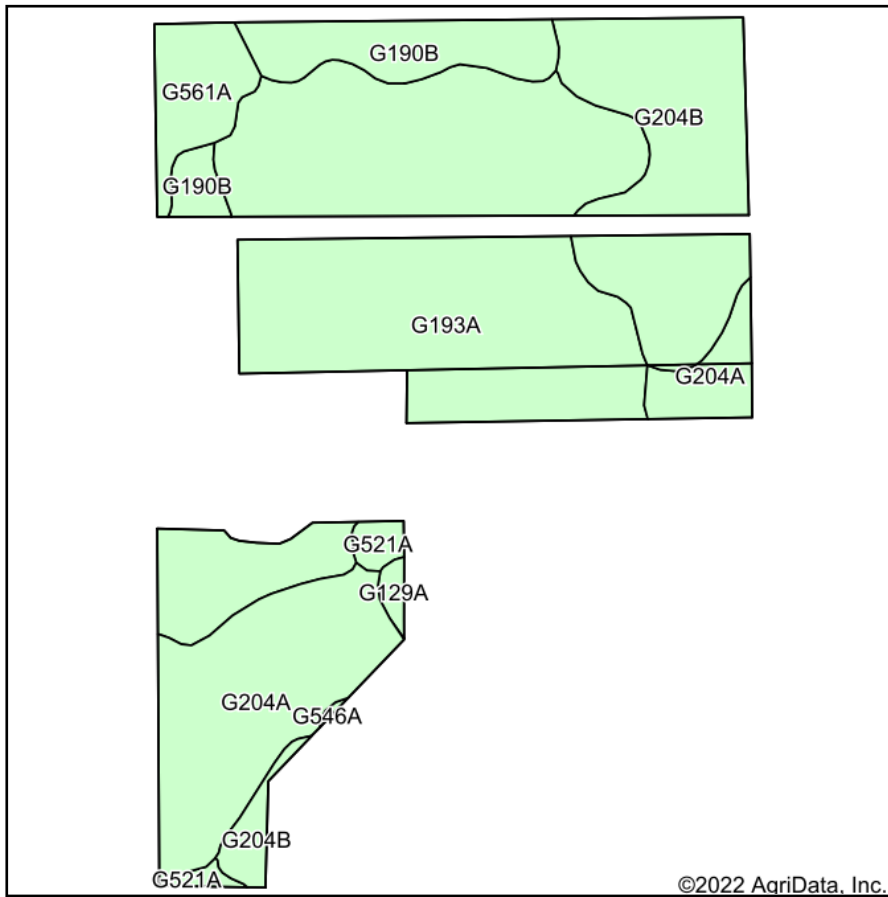

Soils data provided by USDA and NRCS.

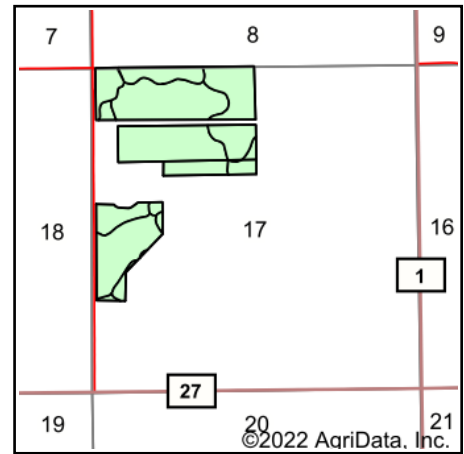

State: **South Dakota**
 County: **Clark**
 Location: **17-117N-59W**
 Township: **Raymond**
 Acres: **117.08**
 Date: **12/1/2022**

ADVANTAGE
Land Co.

Maps Provided By:

 CUSTOMIZED ONLINE MAPPING
 © AgriData, Inc. 2021 www.AgriDataInc.com



Area Symbol: SD025, Soil Area Version: 25

Code	Soil Description	Acres	Percent of field	Non-Irr Class *c	Productivity Index
G193A	Aastad-Forman loams, 0 to 3 percent slopes	58.11	49.6%	IIc	92
G204B	Peever clay loam, 3 to 6 percent slopes	21.60	18.4%	IIIe	66
G204A	Peever clay loam, 0 to 3 percent slopes	21.11	18.0%	IIIs	74
G190B	Forman-Buse-Aastad loams, 1 to 6 percent slopes	8.74	7.5%	IIe	79
G561A	La Prairie loam, 0 to 2 percent slopes, occasionally flooded	5.31	4.5%	IIc	84
G521A	Lowe loam, 0 to 1 percent slopes, occasionally flooded	1.49	1.3%	IVw	41
G129A	Cavour-Ferney loams, 0 to 3 percent slopes	0.63	0.5%	IVs	35
G546A	Lowe loam, saline, 0 to 1 percent slopes, occasionally flooded	0.09	0.1%	IVw	34
Weighted Average				2.22	81.6

*c: Using Capabilities Class Dominant Condition Aggregation Method
 Soils data provided by USDA and NRCS.