

# Soils Map

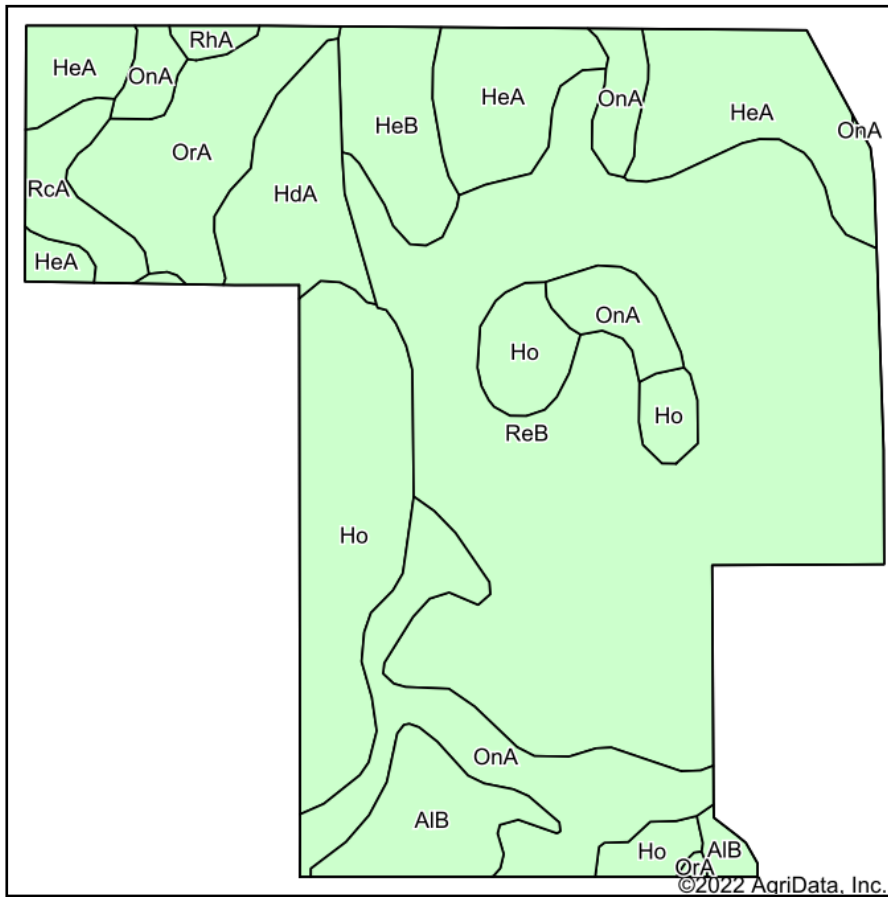

Soils data provided by USDA and NRCS.

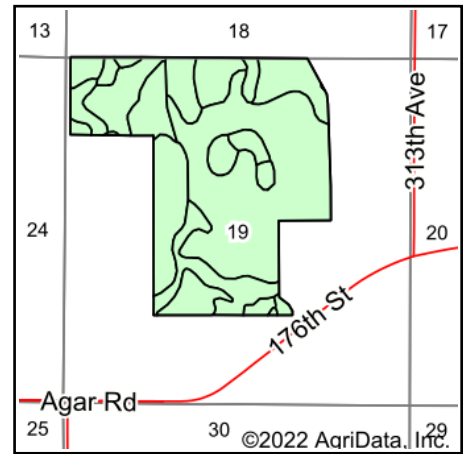

State: **South Dakota**  
 County: **Sully**  
 Location: **19-116N-75W**  
 Township: **East Sully**  
 Acres: **249.48**  
 Date: **8/5/2022**

**ADVANTAGE**  
*Land Co.*

Maps Provided By:



Area Symbol: SD119, Soil Area Version: 24

Code	Soil Description	Acres	Percent of field	Non-Irr Class *c	Productivity Index
ReB	Ree loam, 2 to 5 percent slopes	106.11	42.5%	Ile	80
Ho	Hoven silt loam, 0 to 1 percent slopes	32.44	13.0%	Vls	15
HeA	Highmore silt loam, 0 to 2 percent slopes	29.81	11.9%	Ilc	92
OnA	Mobridge silt loam, 0 to 2 percent slopes	28.59	11.5%	Ilc	94
OrA	Onita-DeGrey silt loams, 0 to 2 percent slopes	15.10	6.1%	Ilc	76
HdA	Highmore-DeGrey silt loams, 0 to 2 percent slopes	11.57	4.6%	Ilc	76
AIB	Akaska silt loam, 2 to 5 percent slopes	10.34	4.1%	Ille	58
HeB	Highmore silt loam, 2 to 6 percent slopes	9.10	3.6%	Ile	91
RcA	Raber-Cavo loams, 0 to 2 percent slopes	5.33	2.1%	Ilc	60
RhA	Eakin-Raber complex, 0 to 2 percent slopes	1.09	0.4%	Ilc	83
<b>Weighted Average</b>				<b>2.56</b>	<b>73.2</b>

\*c: Using Capabilities Class Dominant Condition Aggregation Method  
 Soils data provided by USDA and NRCS.