

Soils Map

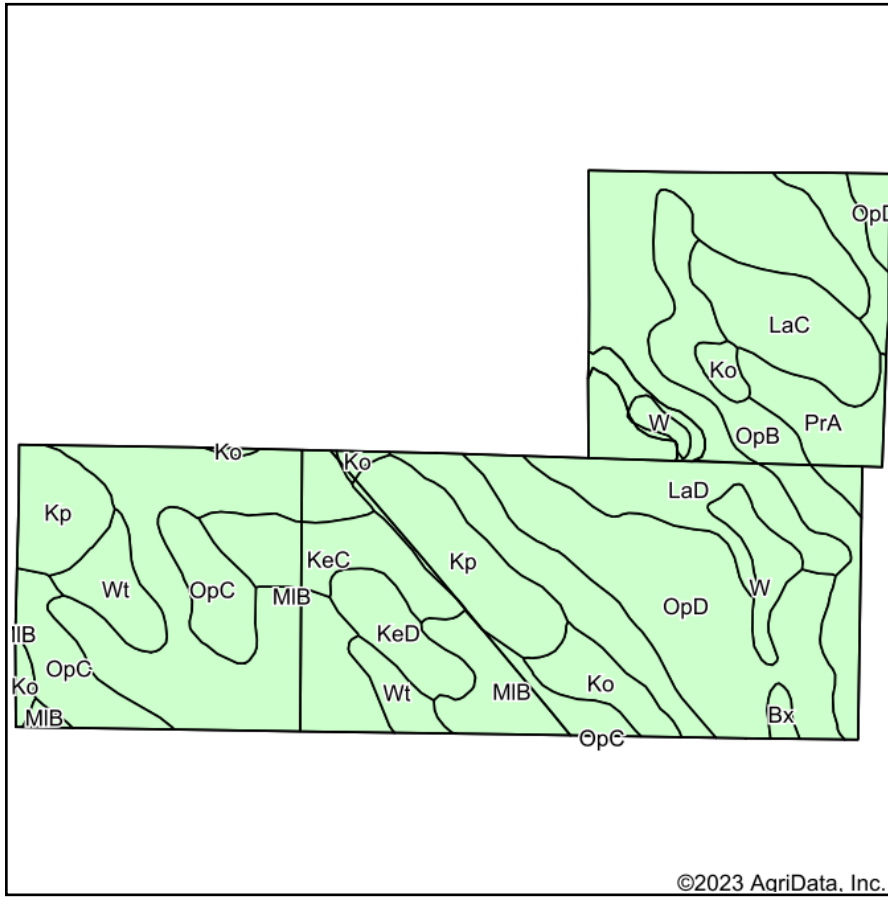

Soils data provided by USDA and NRCS.

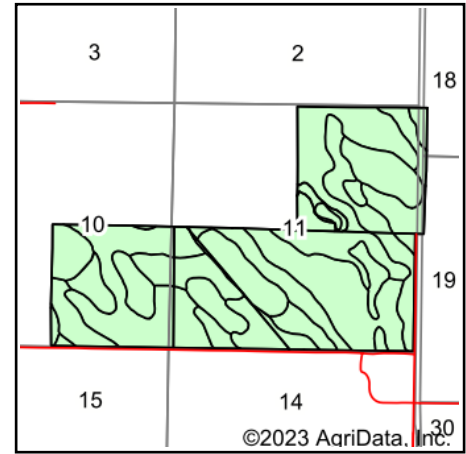

State: **South Dakota**
 County: **Jones**
 Location: **11-2S-31E**
 Township: **Williams Creek**
 Acres: **644.78**
 Date: **9/21/2023**

ADVANTAGE
Land Co.

Maps Provided By:

 CUSTOMIZED ONLINE MAPPING
 © AgriData, Inc. 2023 www.AgriDataInc.com



Area Symbol: SD075, Soil Area Version: 26

Code	Soil Description	Acres	Percent of field	Non-Irr Class *c	Irr Class *c	Productivity Index
MIB	Millboro silty clay, 3 to 6 percent slopes	154.18	23.9%	IIIe	IIIe	79
LaD	Lakoma silty clay, 6 to 15 percent slopes	106.97	16.6%	VIe	VIe	43
OpD	Opal clay, 6 to 15 percent slopes	85.12	13.2%	VIe	VIe	48
Kp	Kolls silty clay, ponded	50.88	7.9%	VIIIw	VIIIw	5
OpB	Opal clay, 3 to 6 percent slopes	42.28	6.6%	IIIe	IIIe	60
OpC	Opal clay, 6 to 9 percent slopes	35.27	5.5%	IVe	IVe	49
LaC	Lakoma silty clay, 6 to 9 percent slopes	31.57	4.9%	VIe	VIe	45
KeC	Kirley clay loam, 6 to 9 percent slopes	27.99	4.3%	IIIe	IIIe	70
Ko	Kolls silty clay	22.43	3.5%	Vw	Vw	30
Wt	Witten silty clay, 0 to 3 percent slopes	22.24	3.4%	IIIs	IIIs	79
PrA	Promise clay, 0 to 3 percent slopes	20.81	3.2%	IIIs	IIIs	68
KeD	Kirley clay loam, 9 to 15 percent slopes	17.10	2.7%	VIe	VIe	57
W	Water	14.33	2.2%	VIII		0
PrB	Promise clay, 3 to 6 percent slopes	11.14	1.7%	IIIe	IIIe	64
Bx	Bullcreek-Slickspots complex, 0 to 6 percent slopes	2.47	0.4%	VIIs	VIIs	9
Weighted Average				4.73	*-	53.2

*c: Using Capabilities Class Dominant Condition Aggregation Method

*- Irr Class weighted average cannot be calculated on the current soils data due to missing data.

Soils data provided by USDA and NRCS.